

MADE IN ITALY

CE c RU US

www.dzump.co.kr



# CX

## REGENERATIVE TURBINE ELECTRIC PUMPS

P503

09/2017

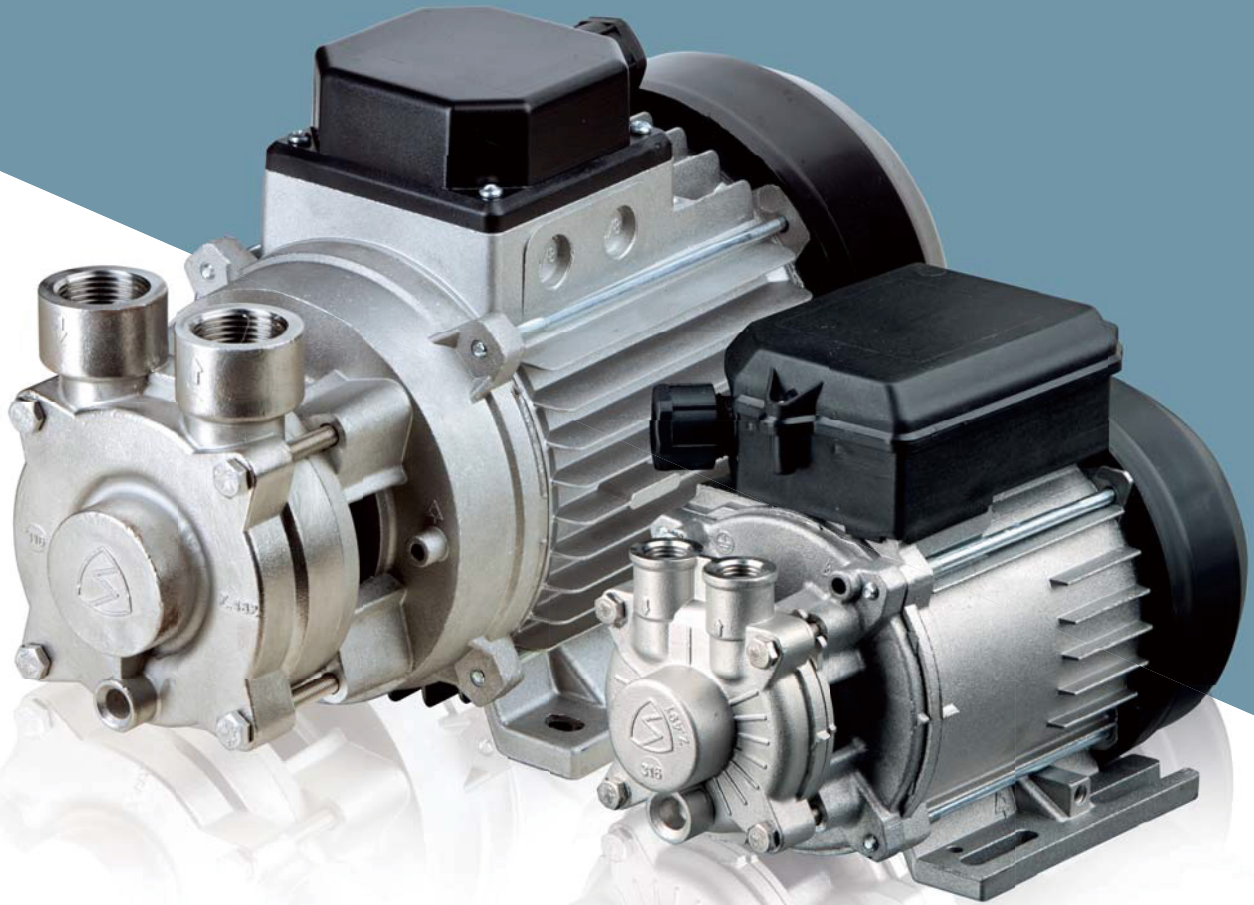

**SIMACO** ELETTROMECCANICA



Fluid Moving Technology



**Duzone systems Co., Ltd.**

키워드 : 더존펌프

CX

P503  
09/2017

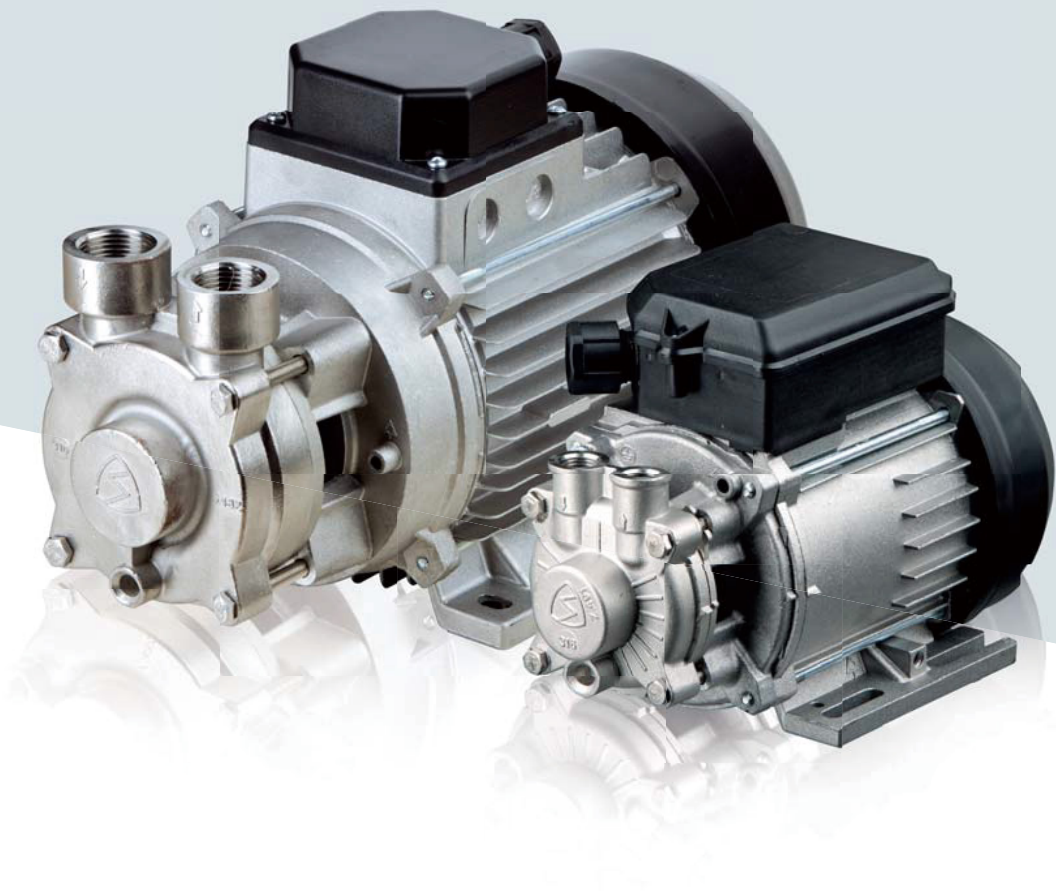

## REGENERATIVE TURBINE ELECTRIC PUMPS

Stainless steel mechanical seal electric surface pumps with peripheral impeller, ideal for increasing or maintaining circulating pressures at medium-low hydraulic flow rates in closed circuit systems. Operation with clear and clean liquids without suspended solids or abrasives. The choice of materials is oriented toward use with oils, demineralized water or slightly aggressive dilutions, and in all those areas where the use of virtually inert components is critical. Pumps specially dedicated to industrial sectors/applications.

Extensive versatility, especially in the dual frequency version, with a wide selection of mechanical seals available on request.

# DIMENSIONS

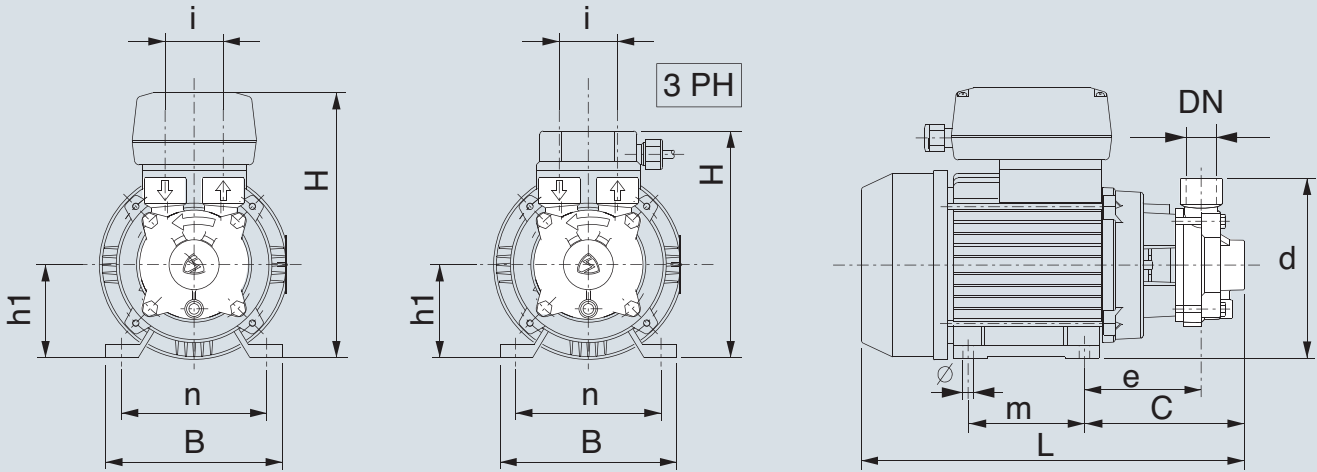

< 01 >

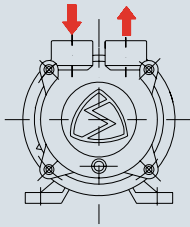

STANDARD

< 02 >

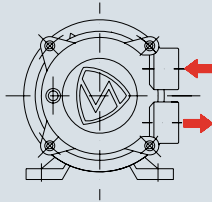

< 03 >

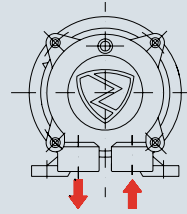

< 04 >

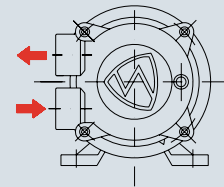

TYPE		P2 (kW)		50/60 Hz DUAL	DN	MATERIALS			DIMENSIONS mm								Kg		
3 phase	1 phase	50 Hz 2800 rpm	60 Hz 3300 rpm			PUMP BODY	IMPELLER	SHAFT	L	B	H	d	n	m	i	e		C	h1
<b>CX 36 DC-24V</b>		See specific brochure P508																	
<b>CX 36</b>		0,14	0,19	<b>O.D.</b>	1/4	AISI316	PEEK	AISI316	185	110	147	100	90	60/85	25	38	59	56	3,8
	<b>CXm 36</b>	0,15	0,22	<b>O.D.</b>	1/4	AISI316	PEEK	AISI316	185	110	147	100	90	60/85	25	38	59	56	3,8
<b>CX 44</b>		0,52	0,72	<b>O.D.</b>	1/2	AISI316	PEEK	AISI316	250	120	161	120	100	80	35	81	105	63	6,5
	<b>CXm 44</b>	0,52	0,72	<b>O.D.</b>	1/2	AISI316	PEEK	AISI316	250	120	172	120	100	80	35	81	105	63	6,5
<b>CX 54</b>		0,65	1	<b>O.D.</b>	1/2	AISI316	AISI316	AISI316	269	135	178	128	112	90	35	79	103	71	9,5
	<b>CXm 54</b>	0,65	1	<b>O.D.</b>	1/2	AISI316	AISI316	AISI316	269	135	190	128	112	90	35	79	103	71	9,5
<b>CX 86</b>		1,3	2,1	<b>O.D.</b>	3/4	AISI316	AISI316	AISI316	316	152	194	154	125	100	50	99	129	80	14,8
	<b>CXm 86</b>	1,3	2,1	<b>R.F.T.</b>	3/4	AISI316	AISI316	AISI316	316	152	227	154	125	100	50	99	129	80	14,8
<b>CX 96</b>		2,1	2,5	<b>R.F.T.</b>	3/4	AISI316	AISI316	AISI316	316	152	194	154	125	100	50	99	129	80	14,8
	<b>CXm 96</b>	2,1	2,5	<b>R.F.T.</b>	3/4	AISI316	AISI316	AISI316	316	152	227	154	125	100	50	99	129	80	14,8

1ph ~ 230V-50Hz | 3ph ~ 230/400V-50Hz - 265/460V-60Hz

1 P2 = Pump absorbed power

## USES AND APPLICATIONS

- Cooling/chiller
- Medical
- Chemical and pharmaceutical
- Sterilisation autoclaves
- Osmosis and filtration
- Robotics and automation
- Water treatment
- Textile

## CHARACTERISTICS

Continuous duty S1. 2 pole motor. Insulation class F. Protection IP42 (IP 54 on demand).

IE3 efficiency class for 3-phase motors >0,75 kW. Working tolerance: +/-10%.

Liquid temperature (with anti-freeze additive): -20°C / +90°C.

Limit ambient temperature: +40°C.

Normal priming, manometer suction up to 5m.

For clear waters/oils and non-aggressive dilutions, without abrasive substances.

**Manufactured in accordance with:** EN 60034-1; EN 60034-30; EN 60335-1; EN 60335-2-41.

**On demand:** Special voltages – 60Hz version – Dual-frequency – Special fluids with temperature <180 °C – UL/CSA.

### 50 Hz

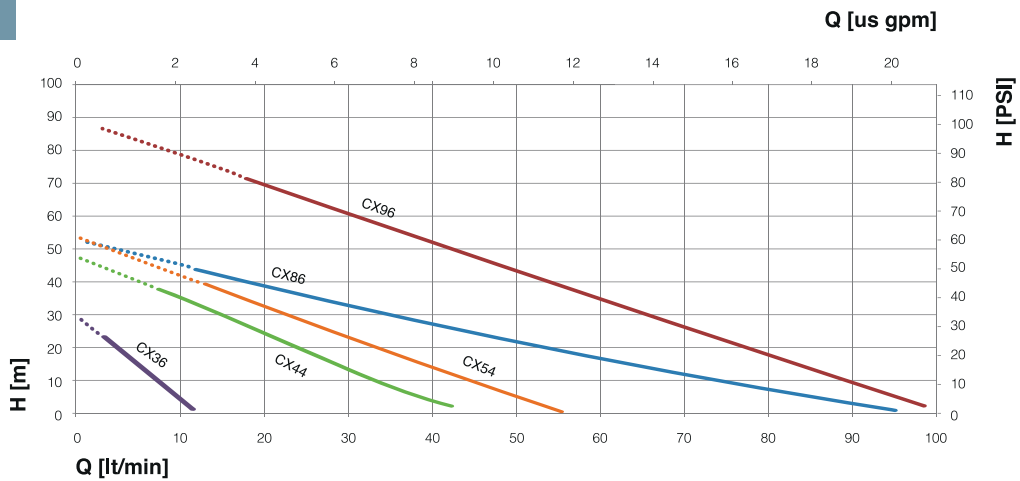

### 60 Hz

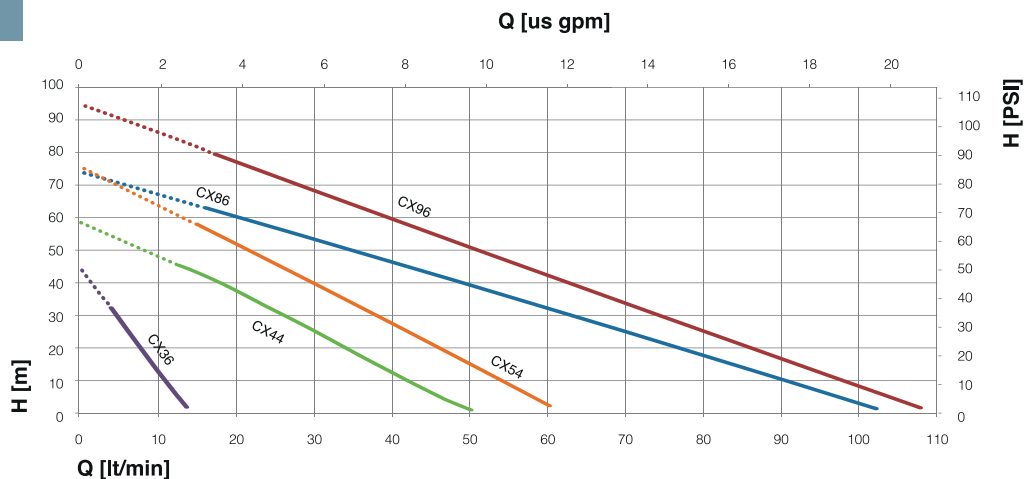

Tolerance according | ISO 9906-2012

Hydraulic characteristics for water 20°C at nominal pump speed

SIMACO reserves the right to make modifications without prior notice.



Fluid Moving Technology

**Duzone systems Co., Ltd.**

97, Siheung-daero, Geumcheon-gu, Seoul, 08639, KOREA

Tel. 02-3286-0036~7

Fax. 02-3286-0038

[www.dzpump.co.kr](http://www.dzpump.co.kr)

E-mail. [dzs2000@naver.com](mailto:dzs2000@naver.com)