



WALRUS
PUMP

TPU Series

Self Priming Pump

IE3 
Motor



**Better Life
Through Innovation**

Content

General Data	03
Performance Range	05
Sectional Drawing	04
Performance Curves/Technical Data	
TPU 550 / 1100 / 1500, (Single Phase)	05
TPU 1100 / 1500, (Three Phase)	06

TPU Series Self Priming Pump

50 Hz

Power: 0.55 - 1.5 kW
 Head: Up to 19 M
 Flow: Up to 415 L/min
 Outlet: 1.5" - 2"
 Inlet: 1.5" - 2"

60 Hz

Power: 0.55 - 1.5 kW
 Head: Up to 28 M
 Flow: Up to 510 L/min
 Outlet: 1.5" - 2"
 Inlet: 1.5" - 2"



Product Features

- Horizontal single stage centrifugal pump, self-priming, co-axial pump/motor design, impellers mounted on extended motor shaft. Main working parts made by stainless steel and engineering plastics.

Applications

The semi-open impeller design prevents blockage caused by suspended solids in the fluid, making it suitable for high-flow rate transfer. And pump casing constructed with high-performance composite materials can be applied in seawater or other saline environments, such as:

- Fishery and transport Sea water
- Seawater Heating and Cooling System
- Gardening or greenhouse sprinkler system
- Agriculture/Industrial/Animal husbandry seawater transferring

Model Code



Operating Conditions

- Ambient Temperature: Max.+40°C
- Liquids Temperature: +4°C ~ +40°C
- System Pressure: Max. 3 kg/cm²
- Inlet Pressure: Max. 0 kg/cm²
- Max. Suction Depth: 6 m
- Kinematical Viscosity: 1 cst (mm²/s)
- Particle Size: 1mm

Motor

- Enclosure protection class: IP54
- Insulation class: F.
- Nominal speed: 2900/3500 rpm
- Frequency range: 50/60 Hz
- Voltages code:

Code	PH	50Hz	60Hz
51R	1	200-240	-
61R	1	-	200-240
6W	3	400	460
9V	3	200-230 / 342-380	220-240 / 380-440

Sectional drawing

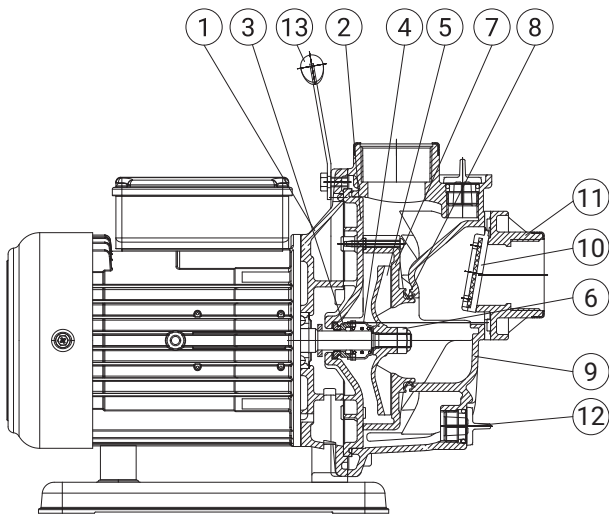

Materials

NO.	Part name	Material
1	Flange Bracket	FC20
2	Intermediate	PPS
3	Mechanical seal	MGSH
4	Sleeve(Mechanical seal)	SUS 316
5	Impeller	SUS 304
6	Nut	SUS 316
7	Intermediate	PPE
8	Gasket	NBR
9	Pump Casing	PPE
10	Check Valve	NBR+SUS304
11	Flange	Nylon
12	Water Plug	Nylon
13	Handle	NBR+SUS304

Performance Curve

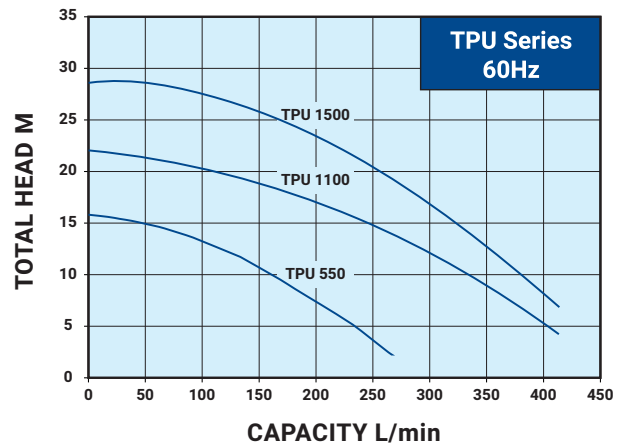
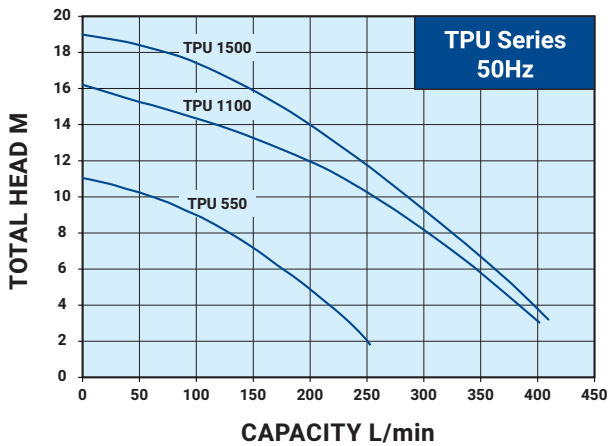

Electrical Data, (Single Phase)

Model	PH ø	Voltage code	Cycle Hz	Volts V	Input kW	Output kW	Ampere A	Inlet in.	Outlet in.	N.W. kg	G.W. kg	
TPU 550	1	51R	50	200-240	0.59	0.55	3.0-2.7	1.5"	1.5"	12	15.4	12
		61R	60		0.90							
TPU 1100	1	51R	50	200-240	1.35	1.10	8.2-6.8	2"	2"	23	24.8	12
		61R	60		1.98							
TPU 1500	1	51R	50	200-240	1.64	1.50	9.3-8.0	2"	2"	25	26.8	12
		61R	60		2.74							

Dimensions

TPU 550

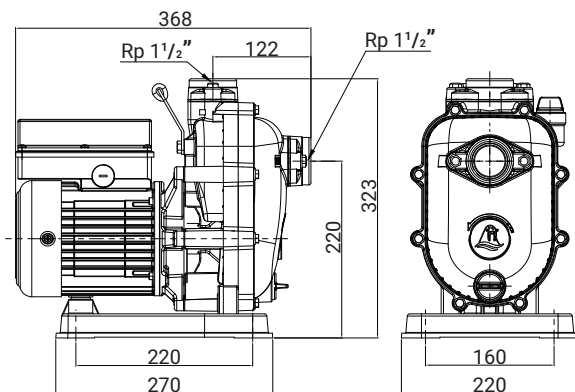

TPU 1100 / 1500

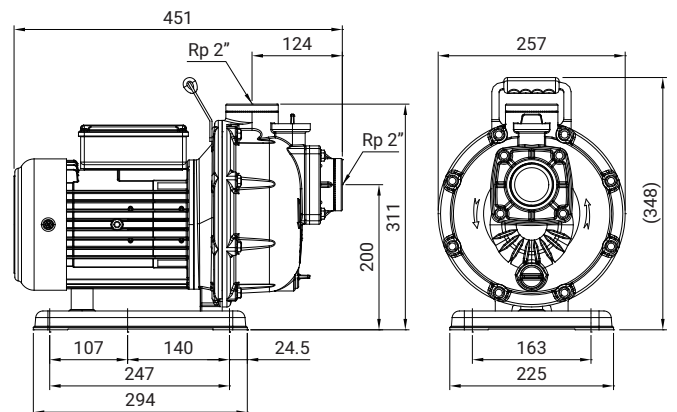

Performance Curve

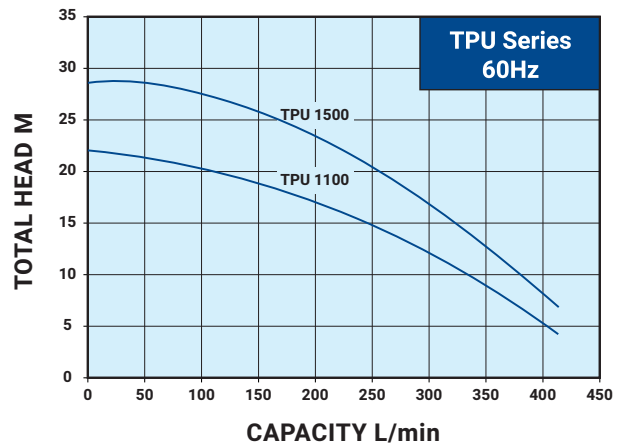
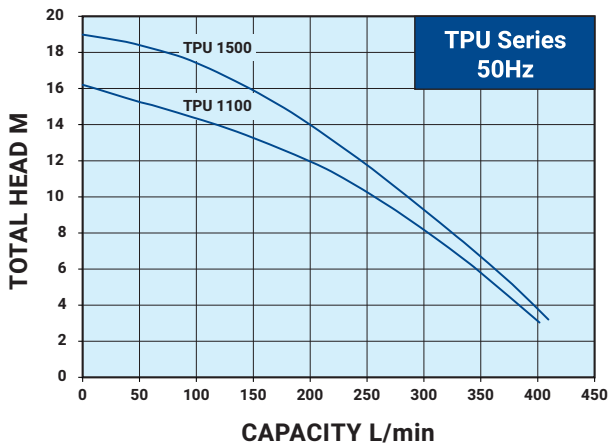

Electrical Cata, (Three Phase), Motor Efficiency IE3

Model	PH ø	Voltage code	Cycle Hz	Volts V	Output kW	Ampere I _{1/1} (A)	Service Factor	Ampere I _{max} (A)	Inlet in.	Outlet in.	N.W. kg	G.W. kg	
TPU 1100	3	6W	50 60	400 460	1.1	3.7 3.2	1.1 1.5	3.9 3.5	2"	2"	23	24.8	12
TPU 1100	3	9V	50 60	200-230 / 342-380 220-240 / 380-440	1.1	5.2-6.0 / 3.0-3.2 4.8-4.7 / 2.8-2.9	1.5	5.5-5.6 / 3.2-3.3 6.0-5.8 / 3.5-3.4	2"	2"	23	24.8	12
TPU 1500	3	9V	50 60	200-230 / 342-380 220-240 / 380-440	1.5	6.3-6.1 / 3.6-3.5 5.8-5.5 / 3.4-3.1	1.5	6.8-6.5 / 3.9-3.7 8.3-7.6 / 4.8-4.2	2"	2"	25	26.8	12

Dimensions

TPU 1100 / 1500

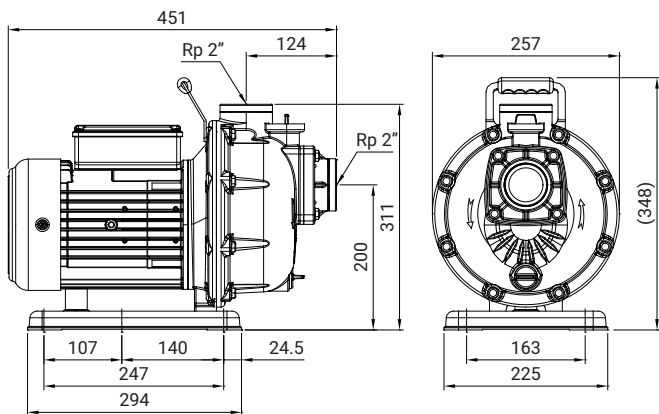



WALRUS
PUMP

Duzone systems Co., Ltd.

Head office : B-1003, 67, Saebitgongwon-ro, Gwangmyeong-si,
Gyeonggi-do, Republic of Korea

Tel : 02) 3286-0036~7

Fax : 02) 3286-0038

Email : dzs2000@naver.com



All specifications are subject to change without notice. TPU-IE3-EN003-202406

